

# GORILLA SPORTS

## FLAT BENCH (100895)

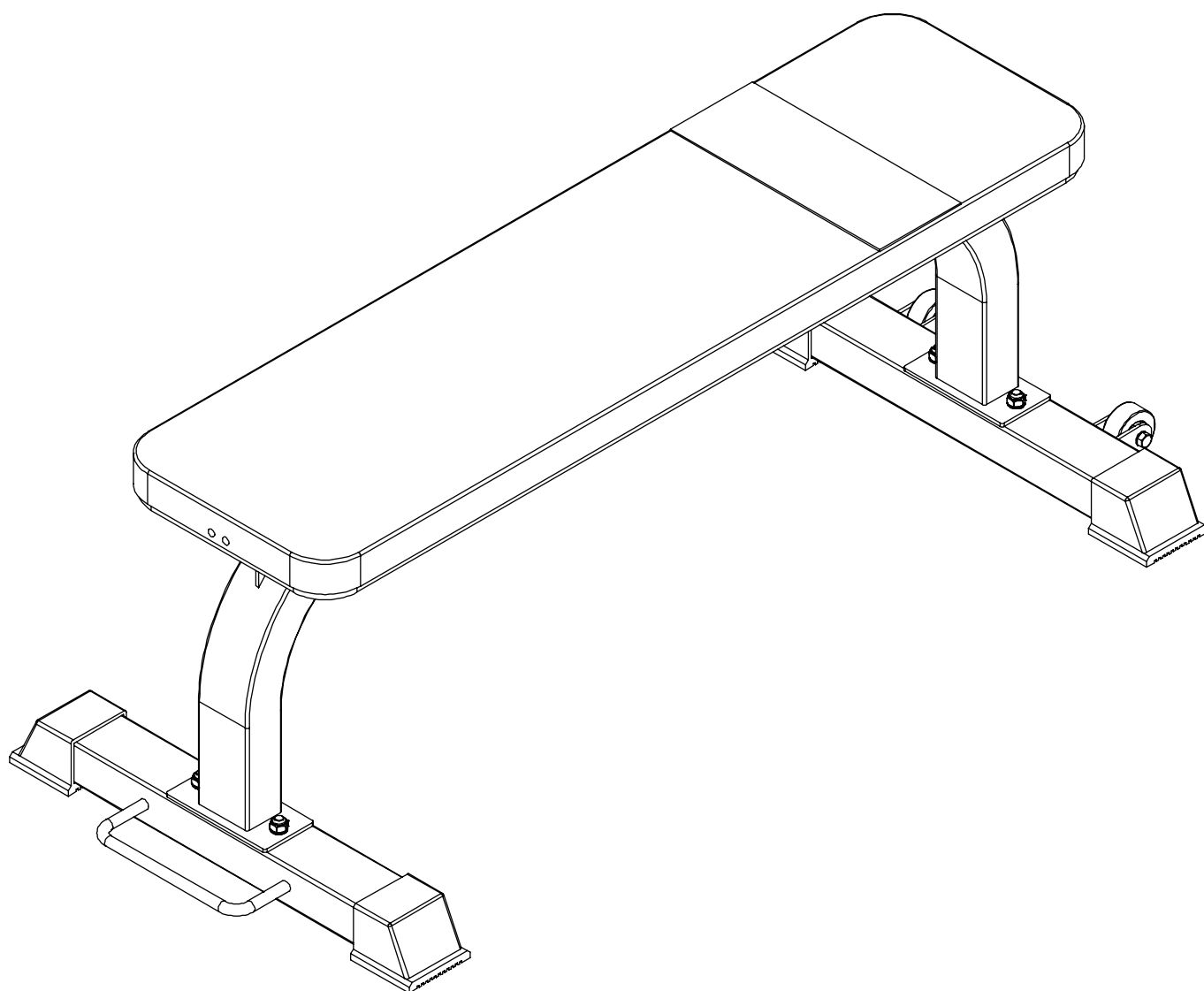

## Table of Contents



# GORILLA SPORTS

## PROFESSIONAL GYM EQUIPMENT FOR EVERYONE

Parametric Diagram.....	3
Product load-bearing instructions.....	4
Spare parts list .....	5
Fasteners drawing .....	6
Assembly step(1).....	7
Assembly step(2).....	8

## Parametric Diagram

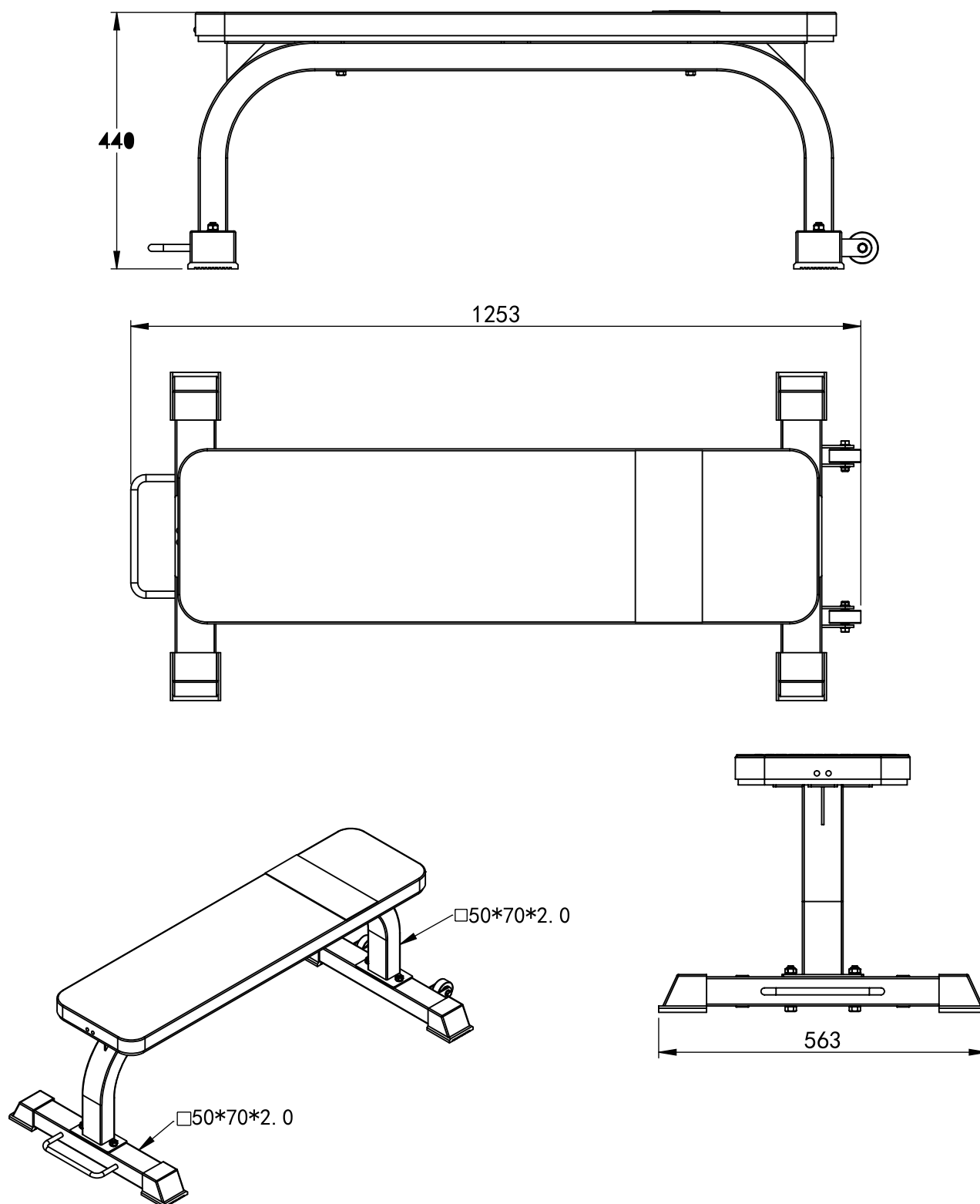

## Product load-bearing instructions

Maximum load 200KG  
Maximum user load 180KG

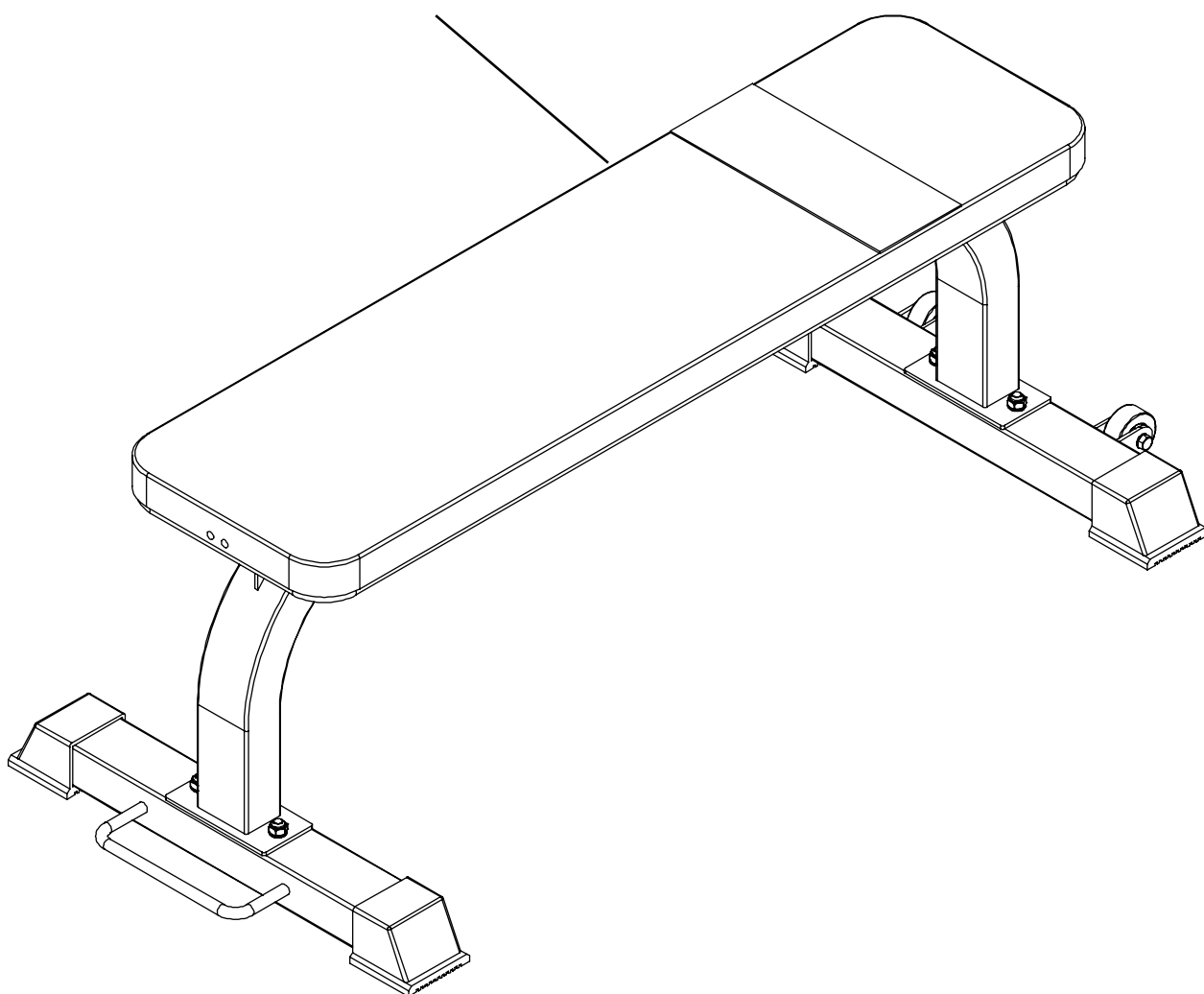

## Spare parts list



# GORILLA SPORTS

## PROFESSIONAL GYM EQUIPMENT FOR EVERYONE

N0.	Description	Note	Qty.
1	front ground tube		1
2	main bending tube		1
3	back ground tube		1
4	hexagon bolt	M10*70	4
5	washer	φ 10	8
6	lock nut	M10	4
7	back cushion		1
8	hexagon bolt	M8*65	2
9	washer	φ8	2



# GORILLA SPORTS

PROFESSIONAL GYM EQUIPMENT FOR EVERYONE

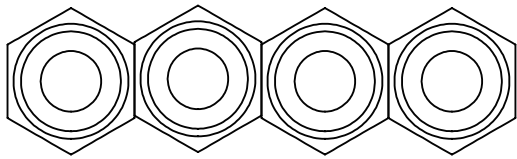

M10 4 PCS

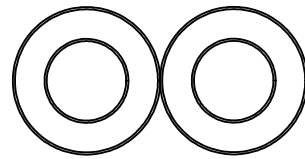

Φ 10 8 PCS

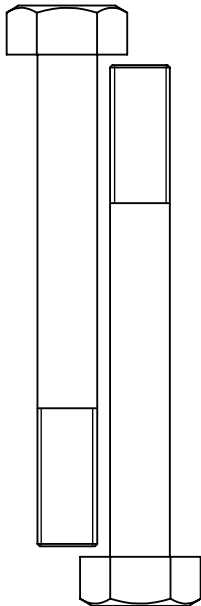

M8\*65 2 PCS

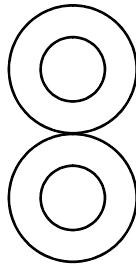

Φ 8 2 PCS

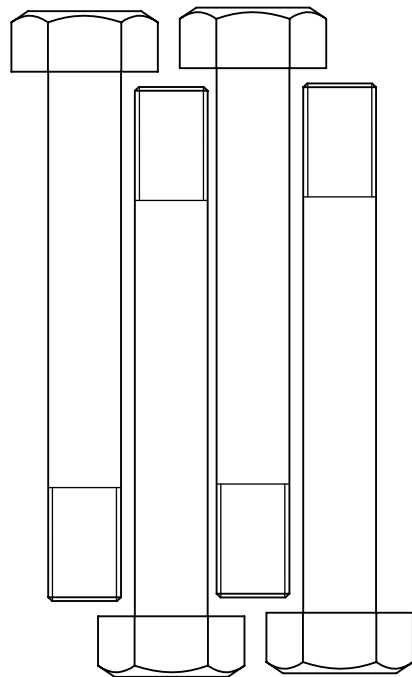

M10\*70 4 PCS

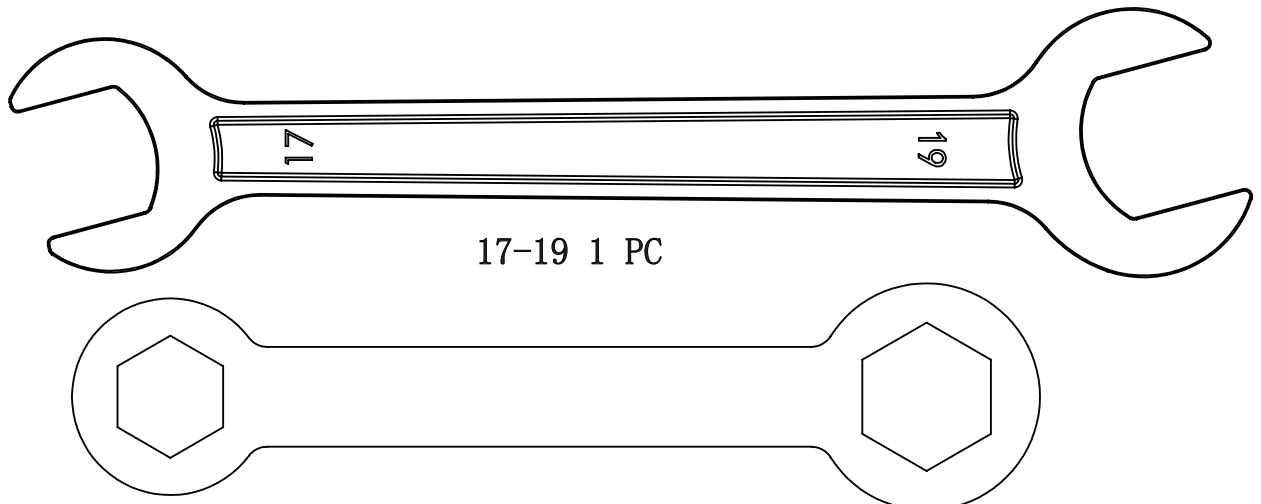

17-19 1 PC

## Assembly step (1) explosion drawing

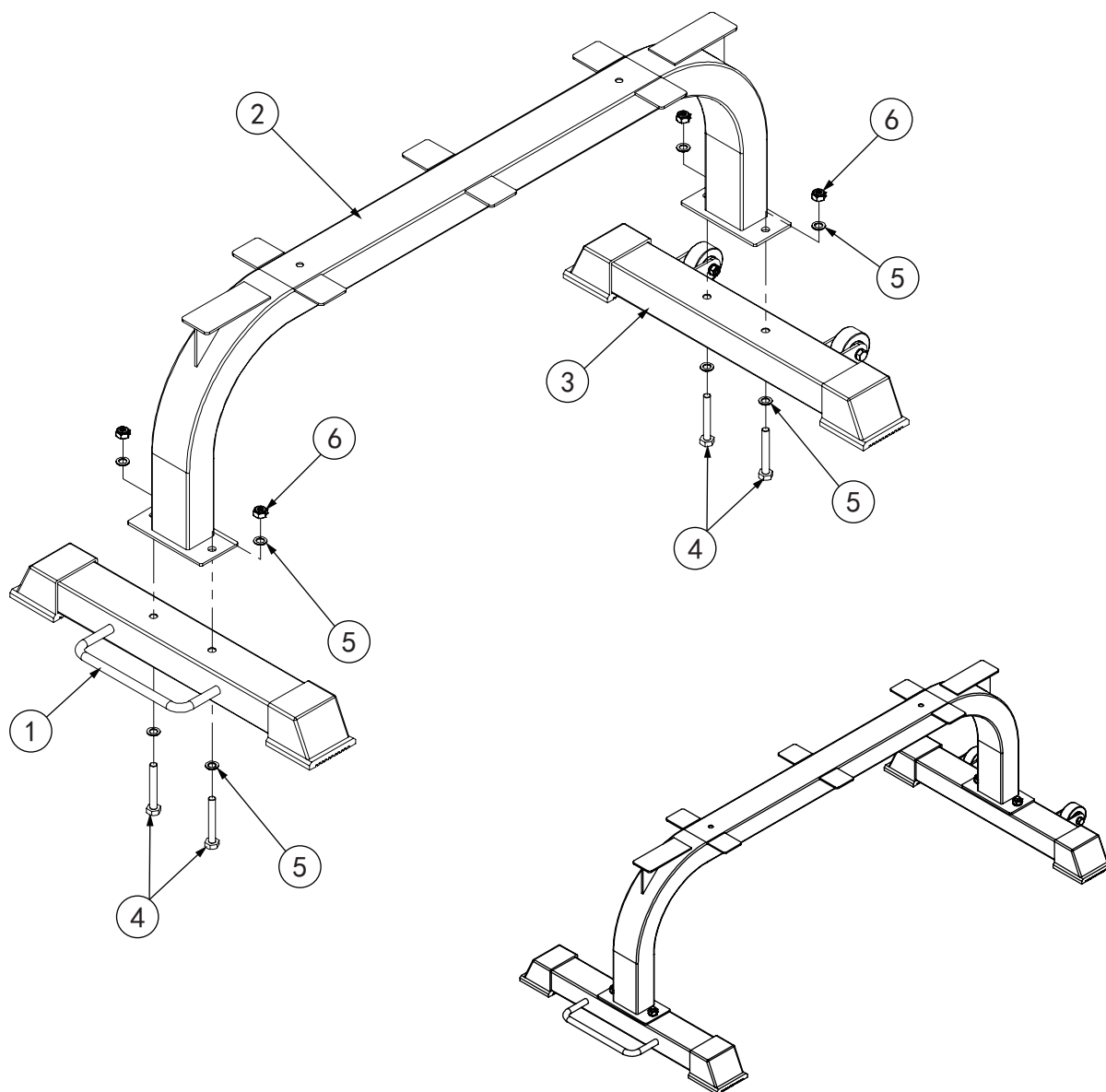

No.	Description	Note	Qty.
1	front ground tube		1
2	main bending tube		1
3	back ground tube		1
4	hexagon bolt	M10*70	4
5	washer	φ 10	8
6	lock nut	M10	4

## Assembly step (2) explosion drawing

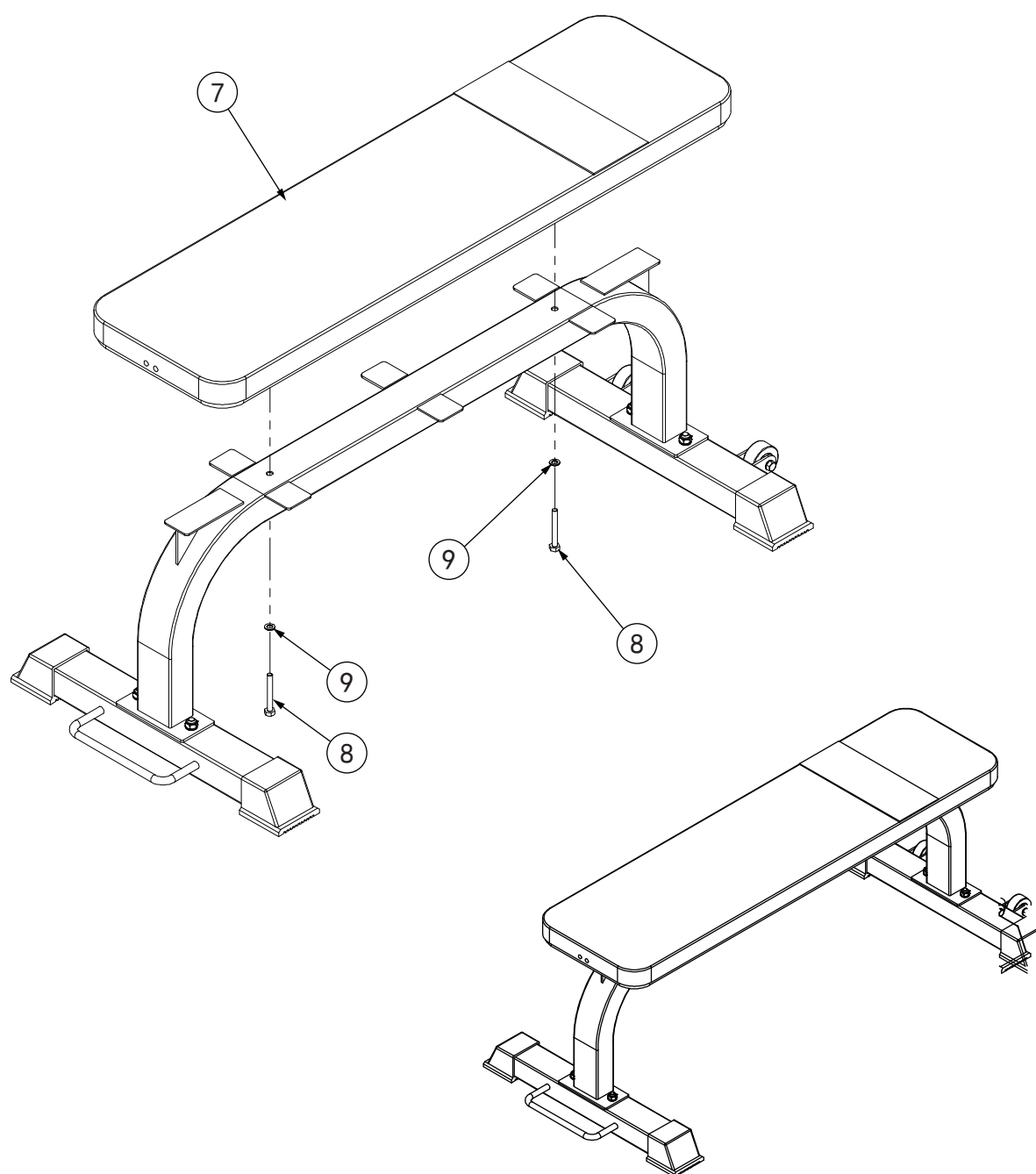

No.	Description	Note	QTY.
7	back cushion		1
8	hexagon bolt	M8*65	2
9	washer	φ 8	2