

GORILLA SPORTS

Squat and Chin Up Rack (100872)

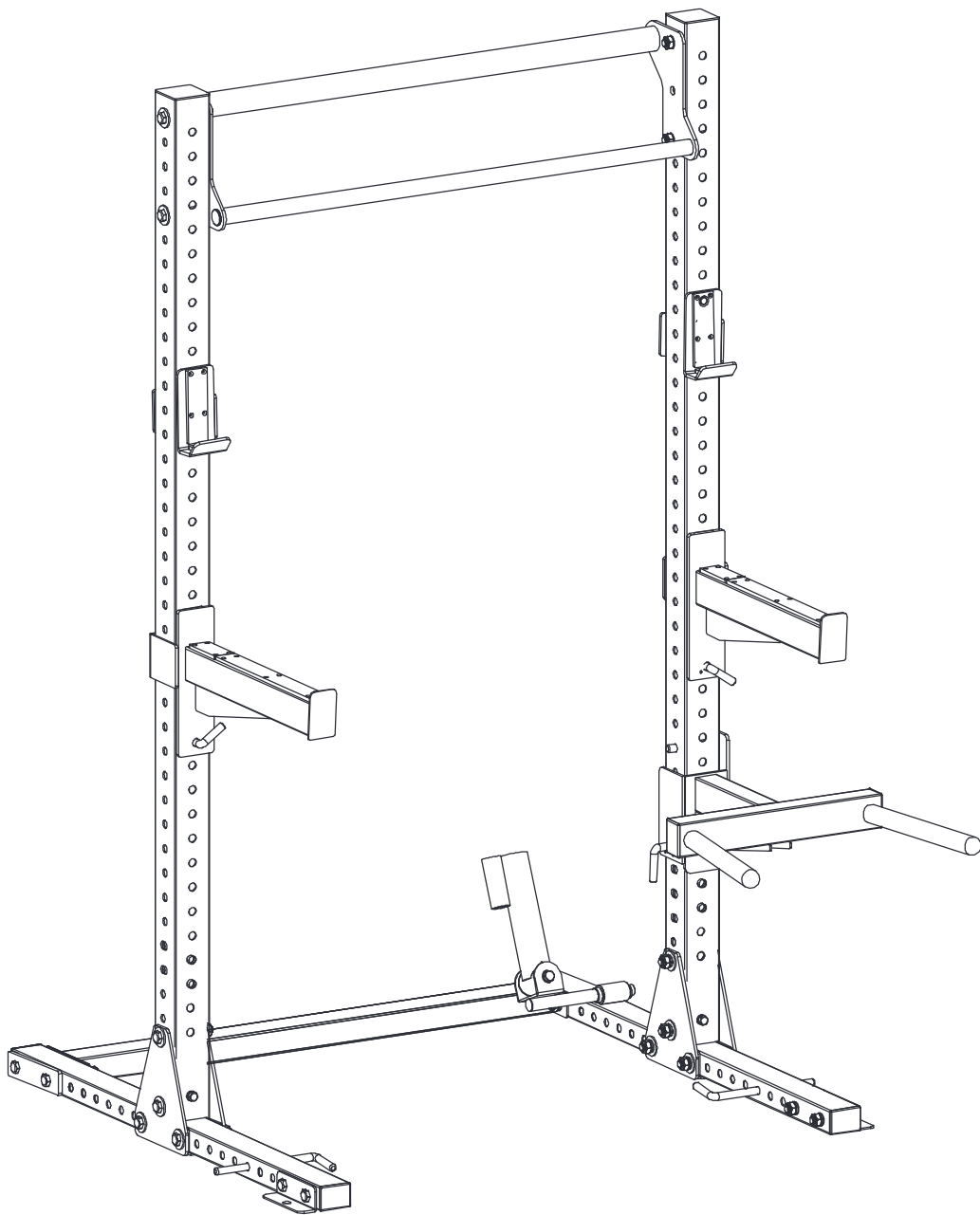

Table of Contents



GORILLA SPORTS

PROFESSIONAL GYM EQUIPMENT FOR EVERYONE

Parametric Diagram.....	3
Product load-bearing instructions.....	4
Spare parts list	5
Fasteners drawing	6
Assembly step(1).....	7
Assembly step(2).....	8
Assembly step(3).....	9
Assembly step(4).....	10
Assembly step(5).....	11
Assembly step(6).....	12

Parametric Diagram

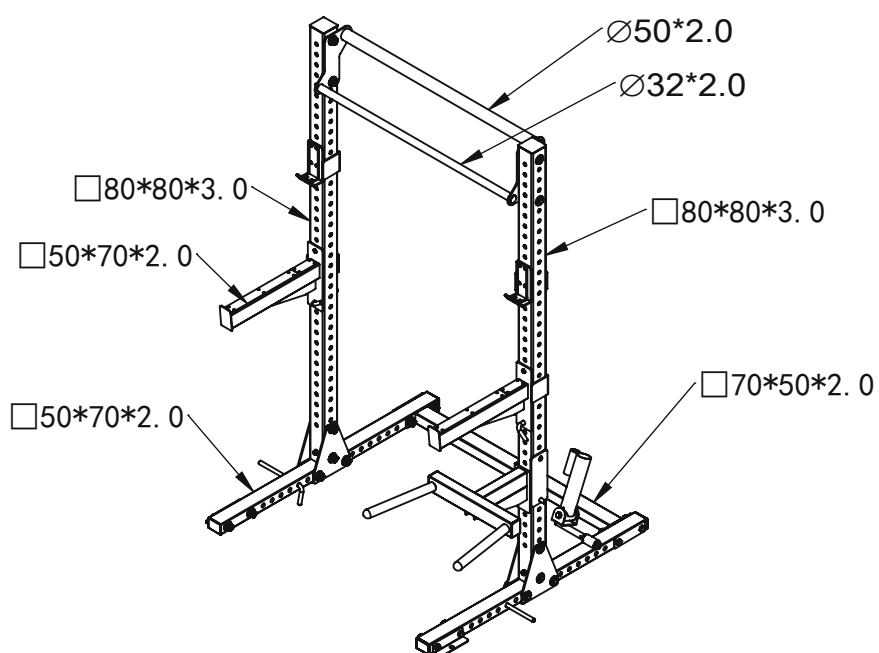
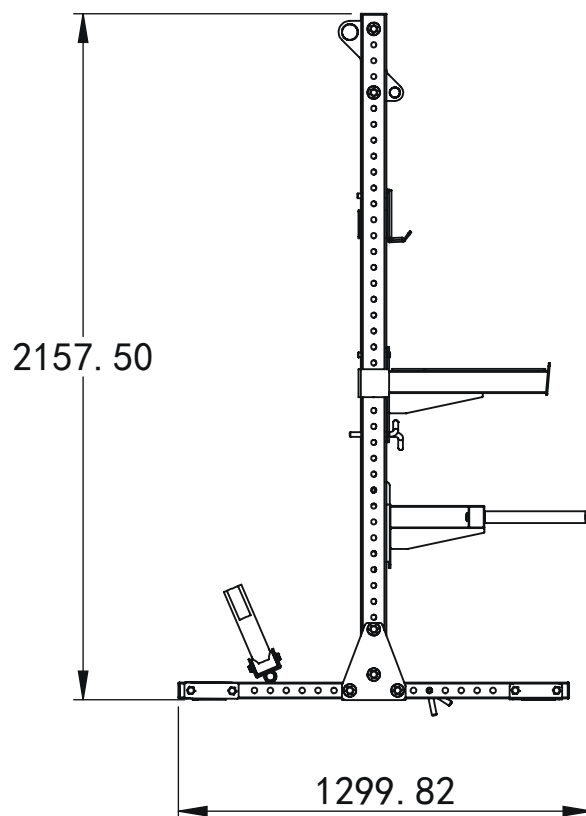
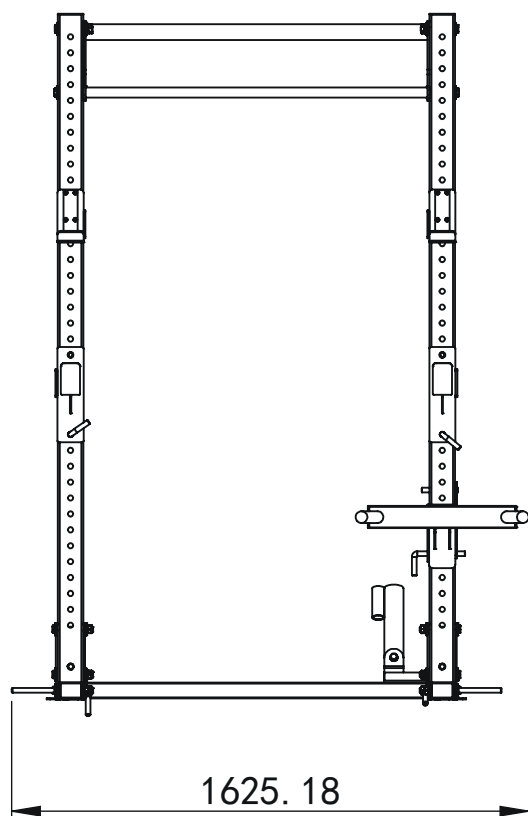

Product load-bearing instructions

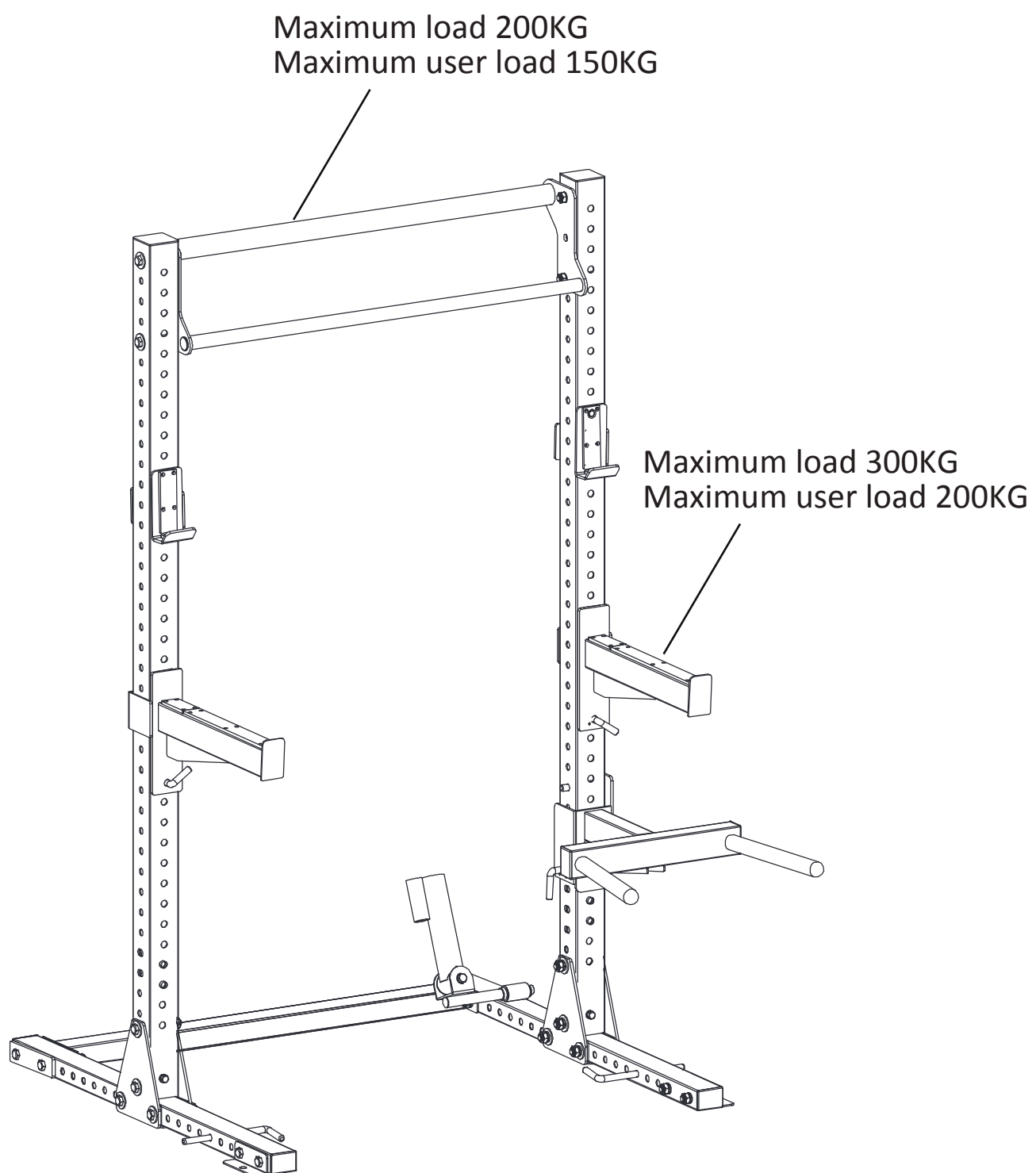

Spare parts list



GORILLA SPORTS

PROFESSIONAL GYM EQUIPMENT FOR EVERYONE

No.	Description	Note	Qty.
1	back base frame		1
2	right base frame		1
3	left base frame		1
4	L shape plate		2
5	hexagon bolt	M16*100	8
6	fixing plate		2
7	hexagon bolt	M16*110	4
8	washer	Φ16	32
9	spring washer	Φ16	20
10	hexagon nut	M16	20
11	upright frame		2
12	hexagon bolt	M10x25	4
13	spring washer	Φ10	4
14	washer	Φ10	4
15	pull up bar		1
16	hexagon bolt	M16*120	8
17	large fixing plate		4
18	L shape pin	Φ17*250	2
19	core trainer		1
20	short barbell holder		2
21	long		2
22	L shape pin	Φ15*110	3
23	dip bar		1



GORILLA SPORTS

PROFESSIONAL GYM EQUIPMENT FOR EVERYONE

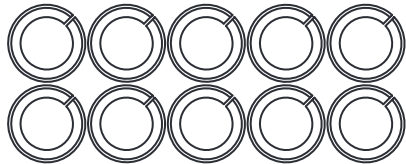

M16 20 PCS (9#)

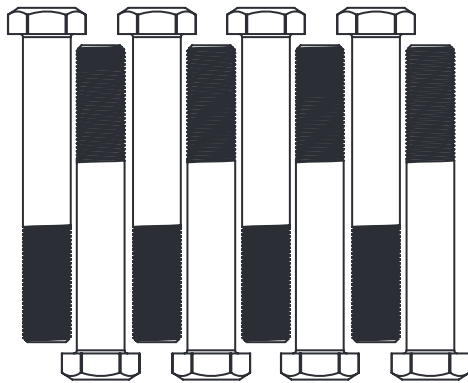
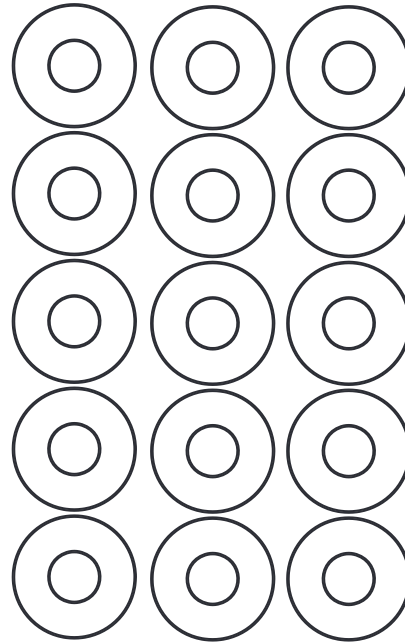

M16*100 8 PCS (5#)

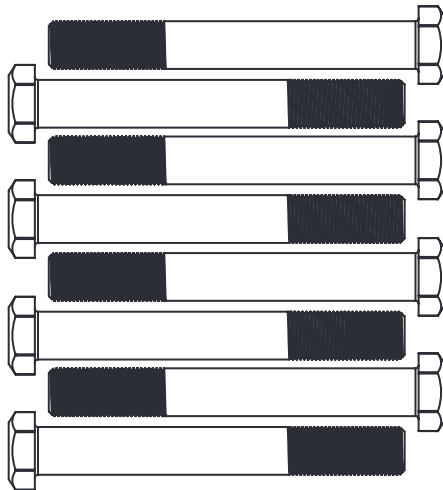

M16*120 8 PCS (16#)



M16*110 4 PCS (7#)

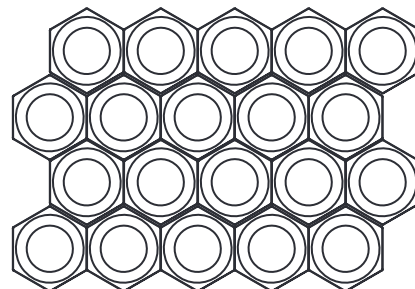

M16 20 PCS (10#)

Assembly step (1) explosion drawing

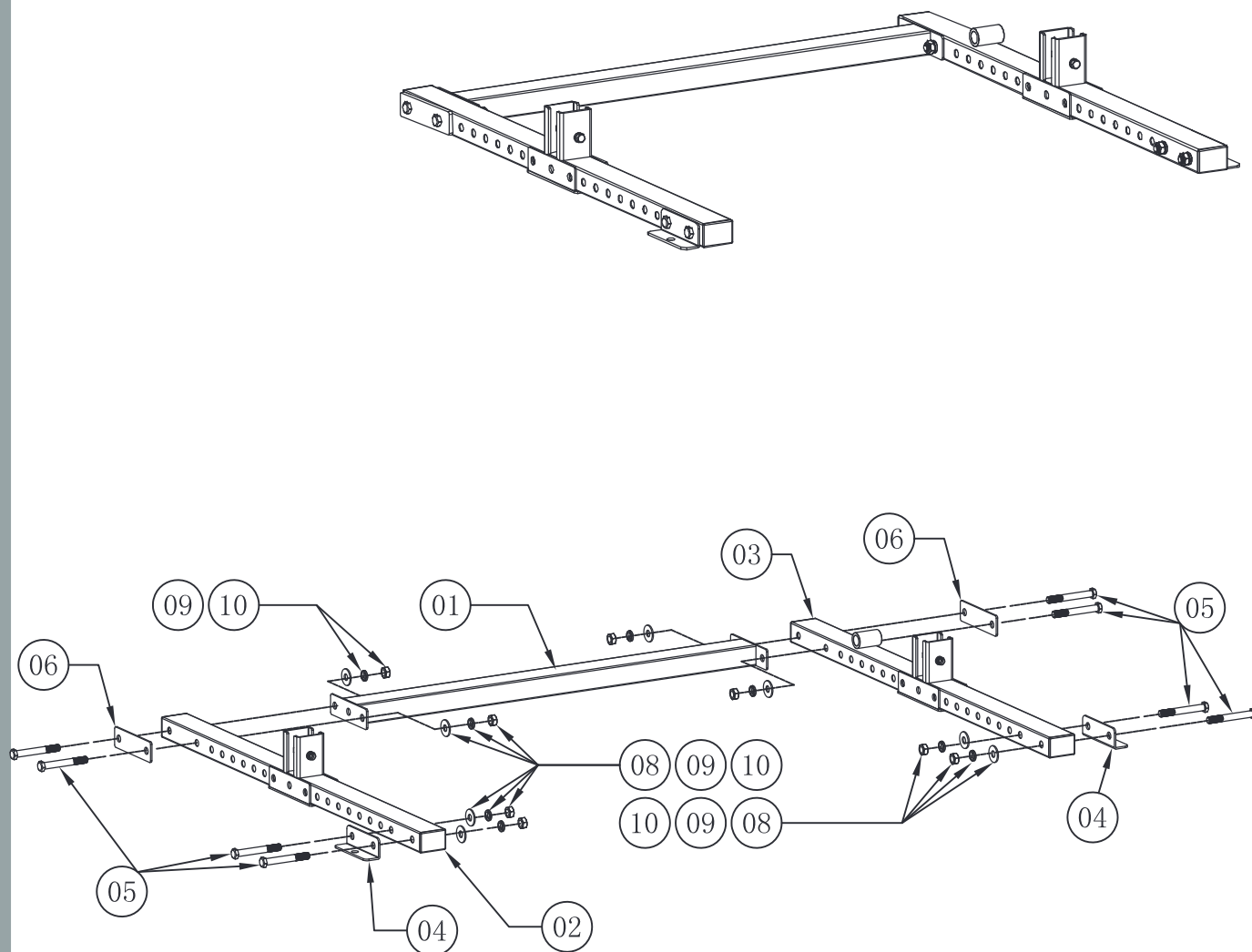

No.	Description	Note	Qty.
1	back base frame		1
2	right base frame		1
3	left base frame		1
4	L shape plate		2
5	hexagon bolt	M16*100	8
6	fixing plate		2
8	washer	Φ16	8
9	spring washer	Φ16	8
10	hexagon nut	M16	8

Assembly step (2) explosion drawing

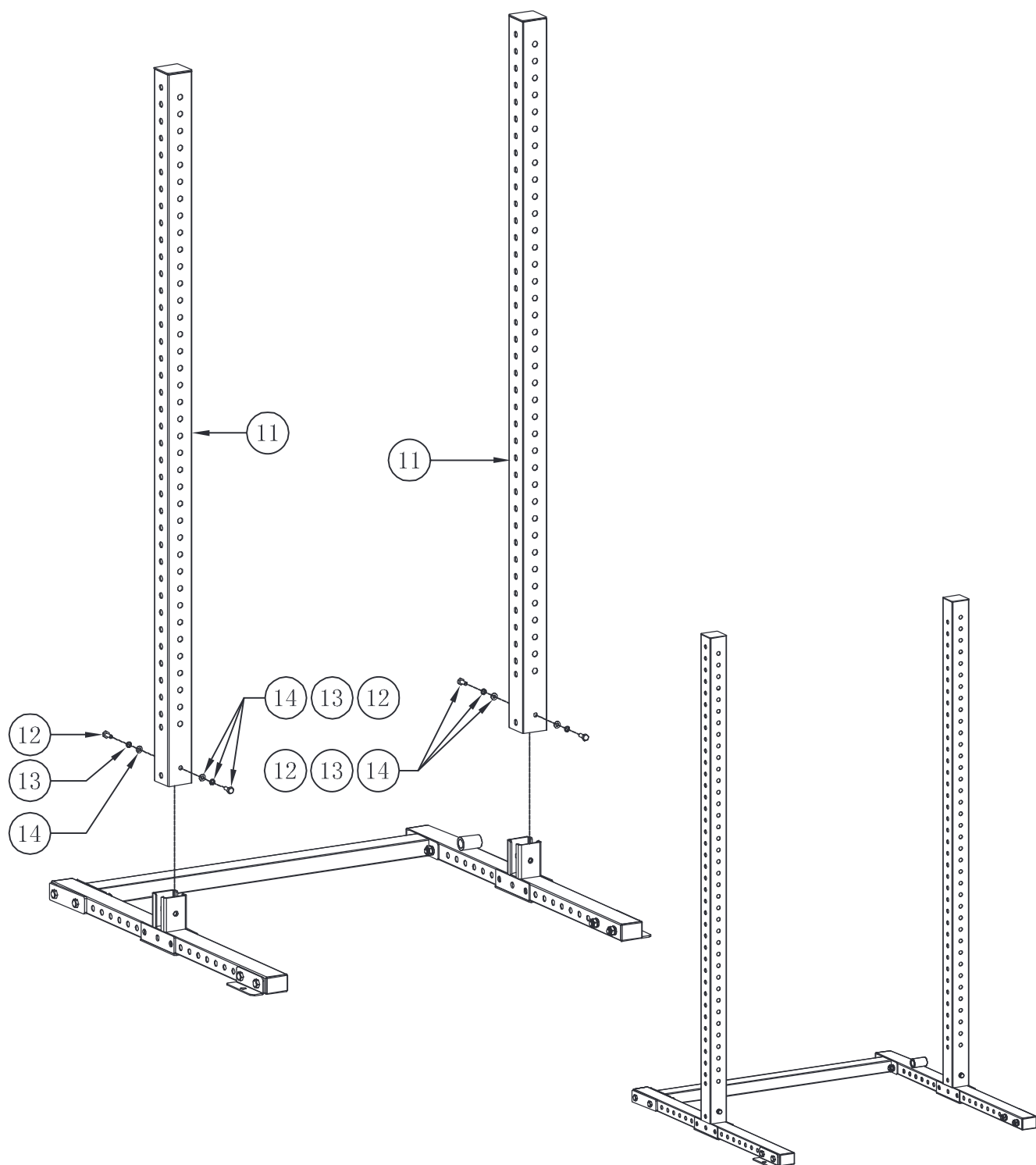

No.	Description	Note	Qty.
11	upright frame		2
12	hexagon bolt	M10x25	4
13	spring washer	Φ10	4
14	washer	Φ10	4

Assembly step (3) explosion drawing

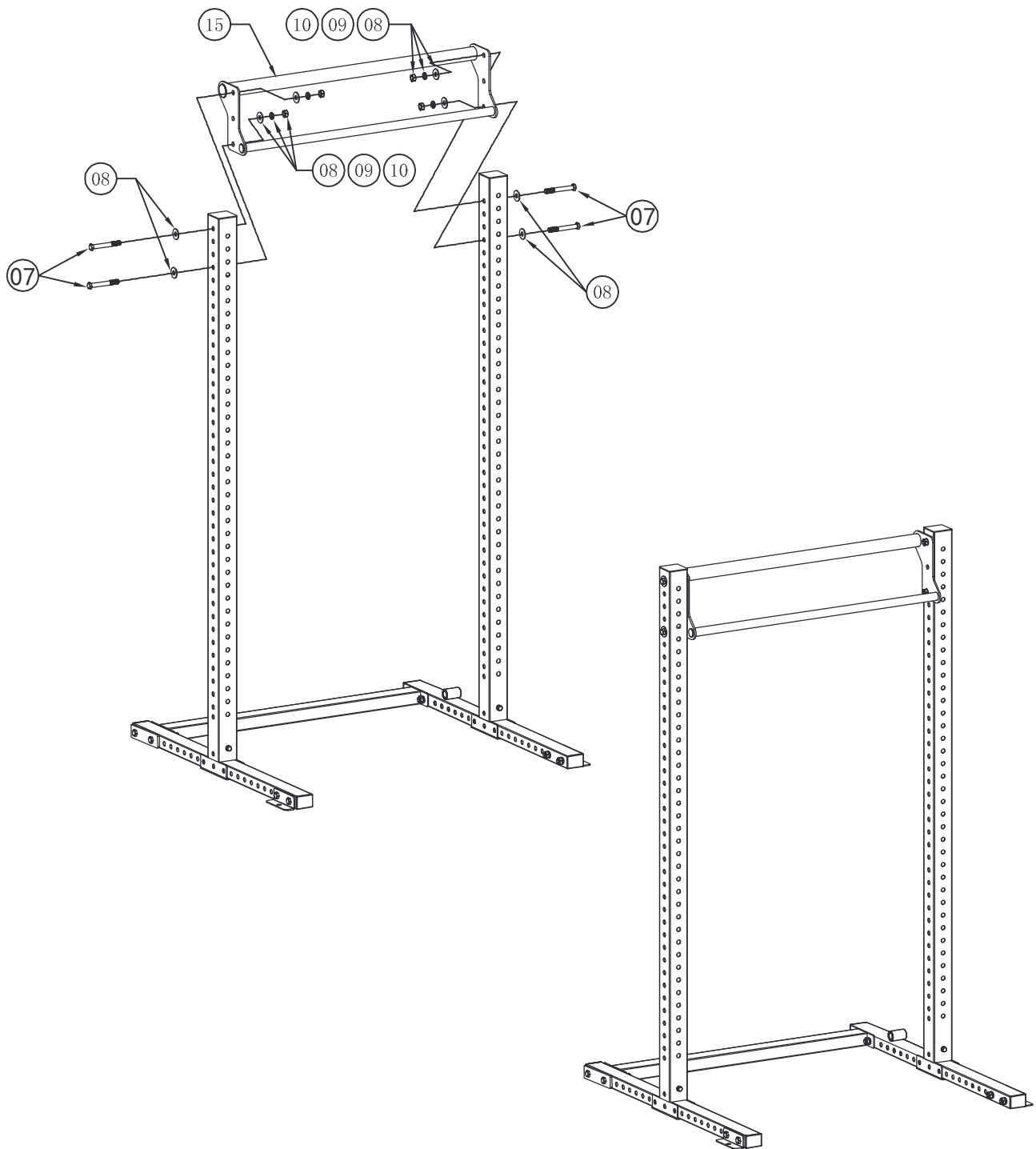

No.	Description	Note	Qty.
7	hexagon bolt	M16*110	4
8	washer	Φ16	8
9	spring washer	Φ16	4
10	hexagon nut	M16	4
15	pull up bar		1

Assembly step (4) explosion drawing

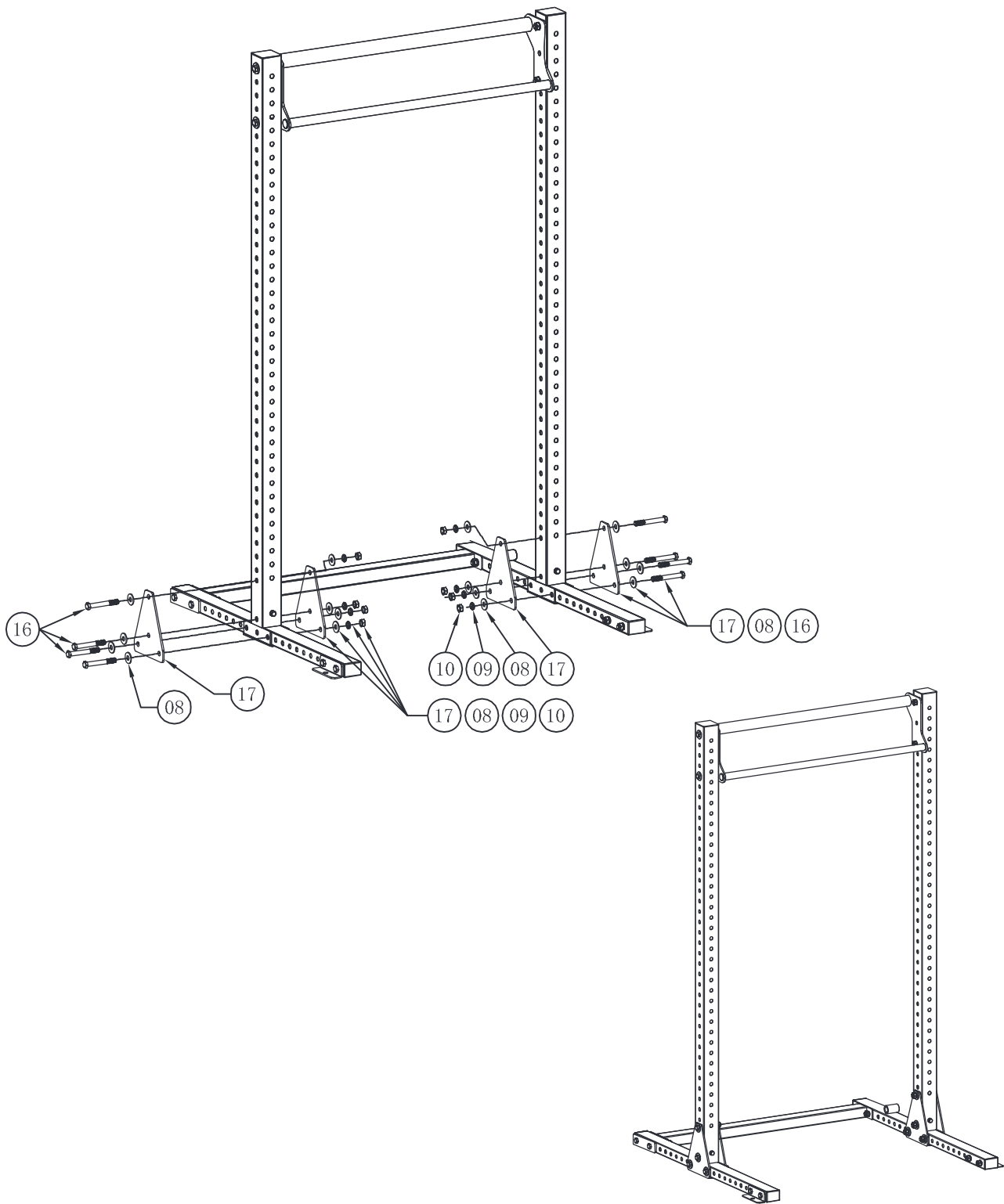

No.	Description	Note	Qty.
8	washer	Φ16	16
9	spring washer	Φ16	8
10	hexagon nut	M16	8
16	hexagon bolt	M16*120	8
17	large fixing plate		4

Assembly step (5) explosion drawing

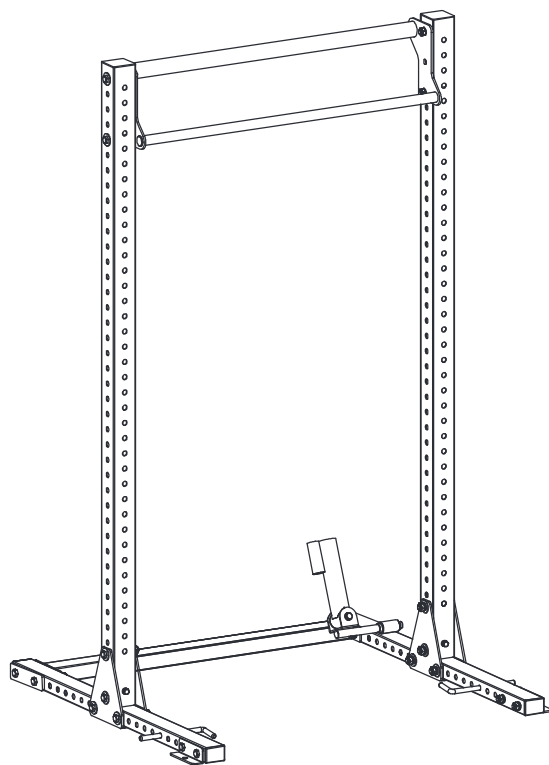
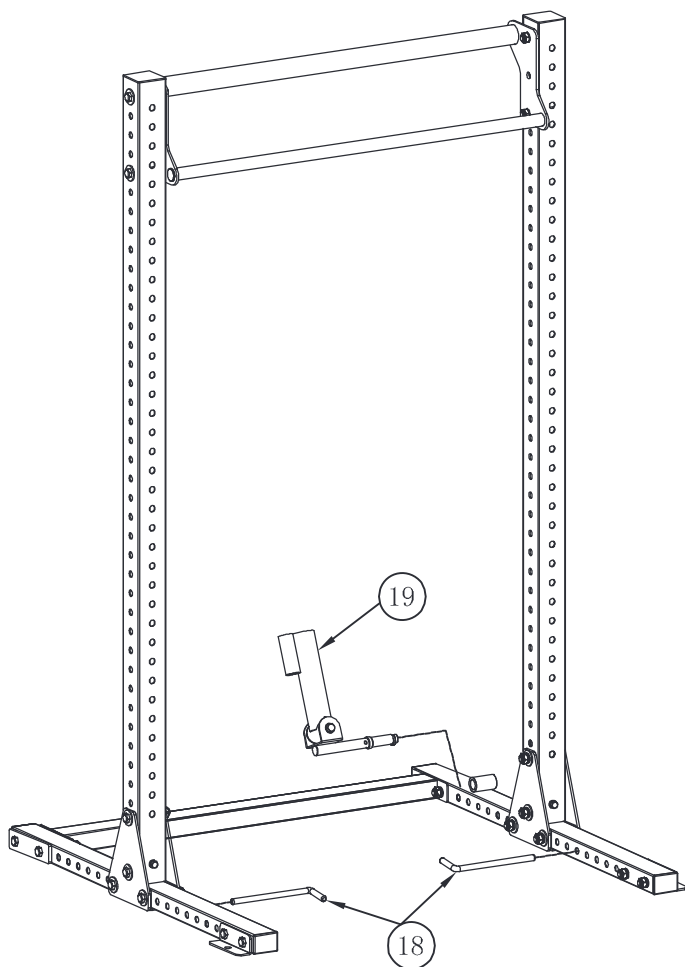

No.	Description
18	L shape pin
19	core trainer

Note
Φ17*250

Qty.
2
1

Assembly step (6) explosion drawing

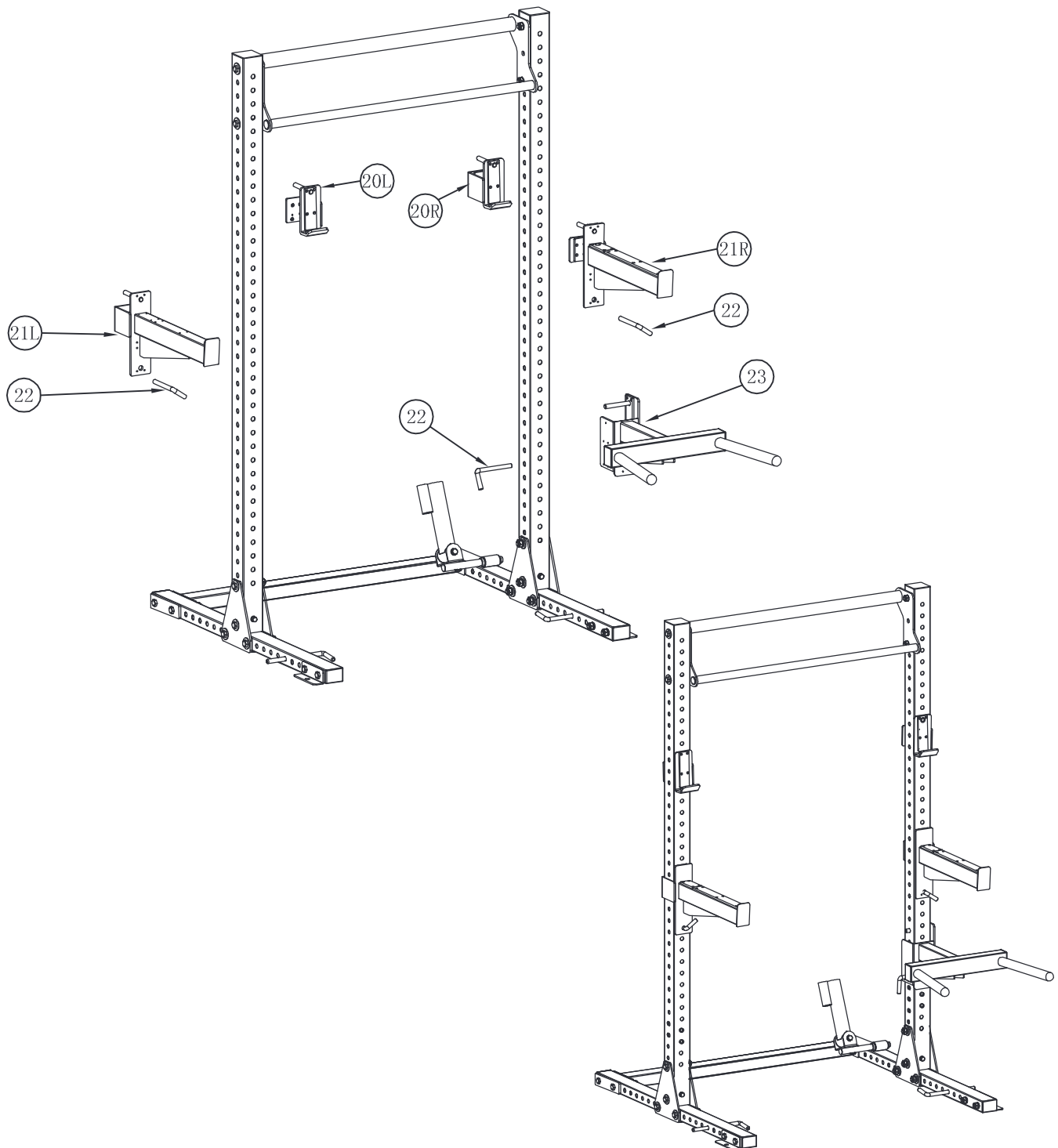

No.	Description	Note	Qty.
20	short barbell holder		2
21	long		2
22	L shape pin	Φ15*110	3
23	dip bar		1